



气浮沉淀一体机

AIR-FLOTATION
PRECIPITATION
INTEGRATED MACHINE

产品目录 PRODUCT CATALOG



青岛颐华环保有限公司

QINGDAO YIHUA ENVIRONMENTAL PROTECTION CO., LTD

气浮沉淀一体机

AIR-FLOTATION PRECIPITATION INTEGRATED MACHINE

产品简介 PRODUCT BRIEF INTRODUCTION >>>

溶气气浮 (DAF) 工艺将液体与固体分离。微小气泡附着在悬浮在液体中的固体颗粒上，导致固体颗粒漂浮。

在 DAF 废水处理系统中，空气在压力下溶解成液体。溶解的空气保留在溶液中，直到压力释放大气压，导致空气以微小气泡的形式从溶液中逸出。气泡附着在废水中的固体上，导致它们漂浮到表面，形成浮毯。然后表面撇渣器除去浮毯。

整套系统可以全自动运行，包括PH控制、混凝剂和聚合物添加、部分回收和循环浮选池。

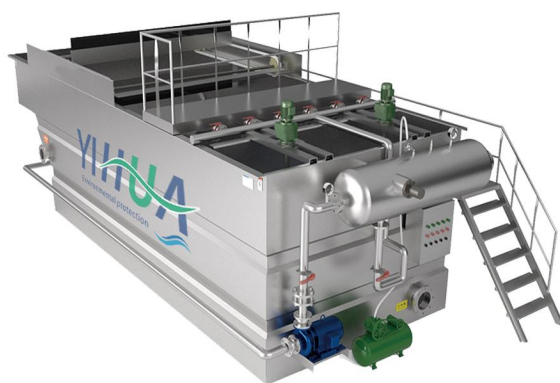

The Dissolved Air Flotation (DAF) process separates liquids from solids. Microscopic air bubbles become attached to solid particles suspended in liquid, causing the solid particles to float.

In a DAF wastewater treatment system air is dissolved into liquid under pressure. The dissolved air remains in solution until the pressure is released to atmospheric pressure, causing the air to come out of solution in the form of microscopic air bubbles. The bubbles become attached to the solids in the wastewater causing them to float to the surface, forming a float blanket. Surface skimmers then remove the float blanket.

Small packaged systems are fully automatic and include pH control, coagulant and polymer additions, partial recycle and circular flotation cells.



工作流程 WORK PROCEDURE >>>

DAF气浮的给水通常（但并非总是）添加混凝剂（例如氯化铁或硫酸铝）以凝结胶体颗粒和/或絮凝剂，从而将颗粒聚集成更大的簇。

离开 DAF气浮的一部分澄清废水被泵入小型压力容器（称为空气溶解罐或饱和器），其中还引入压缩空气。该过程用压力空气 (2.5-4KG/CM2) 饱和加压废水。

饱和空气的水流被循环到浮箱前部，并在进入浮箱前部时流经减压阀，从而导致空气以微小气泡的形式释放出来。

这些气泡附着在进入容器的固体或化学絮凝剂上并与之形成，使它们漂浮到表面，在那里它们被保留并形成浮渣层，随后被撇渣器去除。

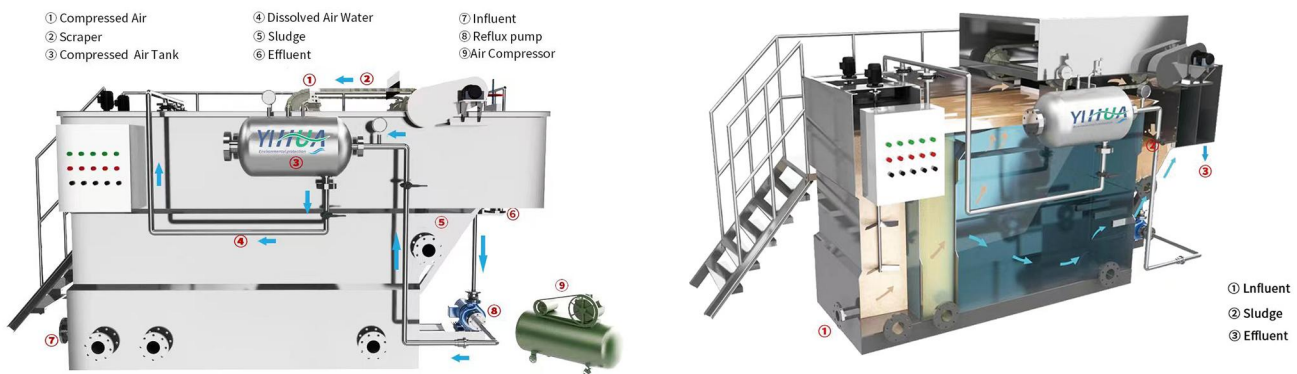

The feed water to DAF float tank is often (but not always) dosed with a coagulant (such as ferric chloride or aluminum sulfate) to coagulate the colloidal particles and/or flocculants to conglomerate the particles into bigger clusters.

A portion of clarified effluent water leaving the DAF tank is pumped into a small pressure vessel (called air dissolving tank or saturator) into which compressed air is also introduced. This process saturates pressurized effluent water with air under pressure (2.5-4kg/cm²).

The air-saturated water stream is recycled to the front of the float tank and flows through a pressure reduction valve just as it enters the front of the float tank, which results in the air being released in the form of tiny bubbles.

These bubbles attach to, and form with, the solids or chemical flocculants entering the vessel, causing them to float to the surface where they are retained and form scum layer, and subsequently removed by a skimmer.

产品优势 PRODUCT SUPERIORITY >>>

- 高速率设计
 - 去除效率高
 - 满足污水排放要求
 - 回收悬浮物质
 - 回收水以供再利用
 - 浆料和污泥的浓缩
 - 应用场景多样
 - 易于操作，不需要过多人力资源
 - 简单、耐用的设计，维护成本低，使用寿命长
- High-rate design
 - High removal efficiency
 - Meet effluent discharge requirements
 - Recovering suspended material
 - Reclaiming water for reuse
 - Thickening of slurries and sludges
 - Application versatility
 - Ease of operation, requiring minimal attention
 - Simple, durable design for low maintenance and long life



应用领域 APPLICATION AREA >>>

除藻·汽车行业·烘焙·废料·压载水·化学加工厂·纤维回收·重金属回收·乳胶厂·肉类包装·油漆废料·宠物食品·制药·马铃薯加工·家禽加工·预制食品·纸浆和造纸厂·炼油厂·海鲜加工·屠宰场·油罐和卡车清洁·纺织品·植物油

Algae Removal·Automotive Industry·Bakery Waste·Ballast Water·Chemical Processing Plants·Fiber Recovery·Heavy Metal Recovery·Latex·Meat Packing·Paint Waste·Pet Foods·Pharmaceutical·Potato Processing·Poultry Processing·Prepared Foods·Pulp and Paper Mills·Refineries·Seafood Processing·Slaughter House·Tank and Truck Cleaning·Textiles·Vegetable Oil



技术参数 TECHNICAL SPECIFICATION >>>

型号 Model	处理量 Capacity (m ³ /h)	管口连接 Piping Connections				尺寸 Dimensionns (mm)					
		进水量 Inlet	出水口 Effluen	排渣口 Sludge	放空口 Vent	L	L1	W1	W2	H1	H
YHDAF-003	3	DN40	DN50	DN100	DN50	4300	3300	800	700	1900	2300
YHDAF-005	5	DN40	DN50	DN100	DN50	4500	3500	100	700	2000	2300
YHDAF-010	10	DN50	DN80	DN100	DN80	5600	4500	1200	700	2000	2300
YHDAF-015	15	DN50	DN100	DN150	DN80	6100	5000	1500	700	2000	2300
YHDAF-020	20	DN50	DN100	DN150	DN80	6100	5000	1800	700	2000	2300
YHDAF-030	30	DN80	DN100	DN150	DN80	7100	6000	2000	700	2000	2300
YHDAF-040	40	DN100	DN150	DN150	DN80	8100	7000	2200	700	2000	2300
YHDAF-050	50	DN100	DN150	DN150	DN80	8100	7000	2700	700	2000	2300
YHDAF-060	60	DN150	DN200	DN150	DN80	9100	8000	2800	700	2000	2300
YHDAF-070	70	DN150	DN200	DN150	DN80	10100	9000	3000	700	2000	2300
YHDAF-080	80	DN150	DN200	DN150	DN100	11100	10000	3200	700	2000	2300
YHDAF-090	90	DN150	DN200	DN150	DN100	11600	10500	3200	700	2000	2300
YHDAF-100	100	DN150	DN200	DN150	DN100	11600	10500	3600	700	2000	2300
YHDAF-150	150	DN200	DN250	DN300	DN100	14500	13400	3600	700	2400	2700
YHDAF-200	200	DN200	DN250	DN300	DN100	18900	17800	3600	700	2400	2700

型号 Model	处理量 Capacity (m ³ /h)	设备重量 Weight	工作重量 Operating weight (kg)	回流泵 Reflux pump (kw)	空压机 Air compressor (kw)	功率 Power	刮渣机 Skimmer (kw)
YHDAF-003	3	1500	5000	0.75	0.55		0.2
YHDAF-005	5	1600	7000	1.1	0.55		0.2
YHDAF-010	10	2000	12000	1.5	0.75		0.2
YHDAF-015	15	2200	18000	1.5	0.75		0.2
YHDAF-020	20	3000	22000	1.5	0.75		0.2
YHDAF-030	30	3800	32000	2.2	1.5		0.2
YHDAF-040	40	5000	45000	4	1.5		0.2
YHDAF-050	50	5500	55000	4	1.5		0.4
YHDAF-060	60	6000	66000	4	1.5		0.4
YHDAF-070	70	6800	85000	5.5	1.5		0.4
YHDAF-080	80	7500	100000	5.5	1.5		0.4
YHDAF-090	90	8300	105000	7.5	1.5		0.4
YHDAF-100	100	9000	110000	7.5	2.2		0.4
YHDAF-150	150	13500	138500	11	2.2		0.4
YHDAF-200	200	17000	170000	15	2.2		0.4

外形图 OUTSIDE VIEW >>>

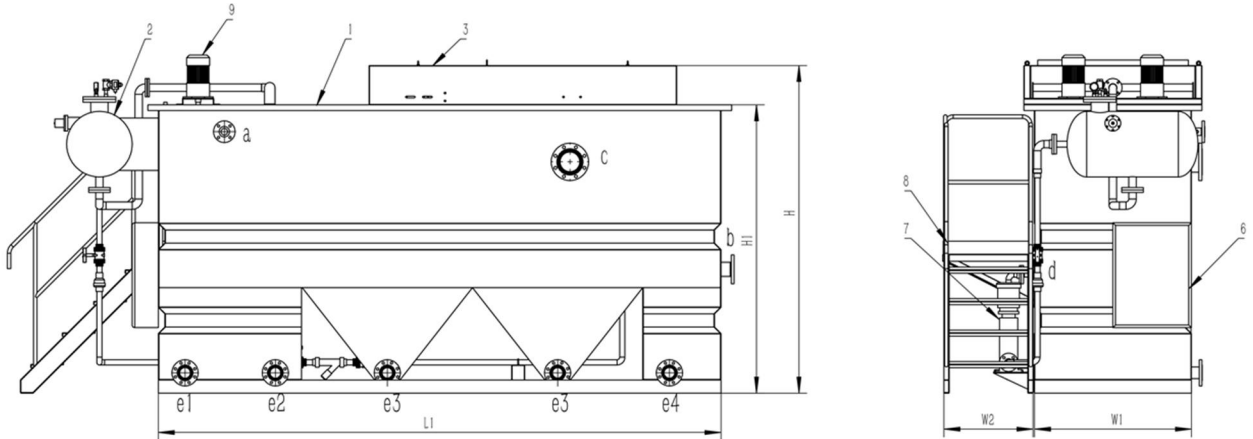

1、设备壳体 2、溶气系统 3、刮渣系统 4、絮凝反应区 5、溶气释放区 6、控制柜 7、回流泵 8、平台护栏
a、进水口 b、出水口 c、排渣口 d、回流口 e1、絮凝反应区放空口 e2、溶气释放区放空口 e3、排泥口 e4、清水区放空口

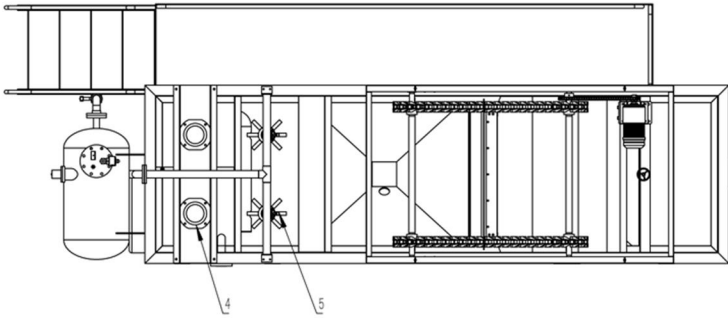

1.Equipment housing 2.Air dissolving system 3.Scraping plates system 4.Flocculation reaction zone 5.Dissolved gas release zone 6.Control cabinet 7.Reflux pump 8.Platform guard

a.Water inlet b.Water outlet c.Slag-drip opening d.Reflux inlet e1.The vent of the flocculation reaction zone e2.Dissolved gas release zone vent e3.Mud outlet e4.Clear water area vent

耗材表 CONSUMABLE LIST >>>

配件名称 Parts Name	配件图片 Accessories Pictures	备注 Remarks
链条 Chain		按照客户要求可自行选配 Optional according to customer requirements
释放器 Releaser		按照客户要求可自行选配 Optional according to customer requirements
橡胶刮板 Rubber Scraper		按照客户要求可自行选配 Optional according to customer requirements
压力表 Pressure Gauge		按照客户要求可自行选配 Optional according to customer requirements
浮球液位开关 Float level switch		按照客户要求可自行选配 Optional according to customer requirements

青岛颐华环保有限公司

QINGDAO YIHUA ENVIRONMENTAL PROTECTION CO., LTD

地址：山东省青岛市西海岸新区明关路729号
ADD: NO.729, MINGGUAN ROAD, WEST COAST NEW DISTRICT,
QINGDAO, SHANDONG, CHINA

电话Tel: +86 532 85138788

网址Web: www.yihuaep.com



QINGDAO YIHUA ENVIRONMENTAL PROTECTION CO., LTD